

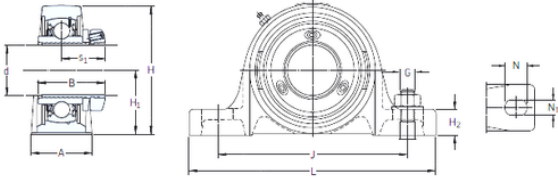

NTN BEARUNG DRIVESHAFT, INC.

SKF SY 2.7/16 PF/AH bearing units



Bearing No. SY 2.7/16 PF/AH

SY 2.7/16 PF/AH Bearing 2D drawings and 3D CAD models

Bore Diameter	61,9125 mm
Width	58,7 mm
d	61,9125 mm
s1	37,5 mm
A	60 mm
B	58,7 mm
G	16 mm
H	139,7 mm
H1	69,9 mm
H2	26 mm
J	190,5 mm
L	240 mm
N	29 mm
N1	18 mm
Weight	5 Kg
Basic dynamic load rating (C)	52,7 kN
Basic static load rating (C0)	36 kN
Category	Pillow Block Bearings
Inventory	0.0
Manufacturer Name	SKF
Minimum Buy Quantity	N/A
Weight / Kilogram	4.634
EAN	7316571834610
Product Group	M06110
Number of Mounting Holes	2
Mounting Method	Stepped Sleeve



NTN BEARUNG DRIVESHAFT,INC.

Housing Style	2 Bolt Pillow Block
Rolling Element	Ball Bearing
Housing Material	Cast Iron
Expansion / Non-expansion	Non-expansion
Mounting Bolts	5/8 Inch
Relubricatable	Yes
Insert Part Number	YSP 212-207-2F/AH
Seals	M Seal
Housing Configuration	1 Piece Solid
Inch - Metric	Inch
Other Features	Single Row Standard Duty Wide Inner Race Air Handling Anti Rotation Pin Has Flinger Y Bearing With Grub Screw
Long Description	2 Bolt Pillow Block; 2-7/16" Bore; 2-3/4" Base to Center Height; Stepped Sleeve Mount; Ball Bearing; 7-1/16" Minimum Bolt Spacing; 7-15/16" Bolt Spacing Maximum; Relubricatable; Ca
Category	Pillow Block
UNSPSC	31171511
Harmonized Tariff Code	8483.20.40.40
Noun	Bearing
Keyword String	Pillow Block
Manufacturer URL	http://www.skf.com
Manufacturer Item Number	SY 2.7/16 PF/AH
Weight / LBS	11
Nominal Bolt Center to Center	7.3 Inch 184 Millimeter
Length Thru Bore	2.313 Inch 58.75 Millimeter
Bolt Spacing Maximum	7.938 Inch



NTN BEARUNG DRIVESHAFT,INC.

	201.625Millimeter
Bolt Spacing Minimum	7.063 Inch 179.4Millimeter
Base to Center Height	2.75 Inch 69.85 Millimeter
Actual Bolt Center to Center	0 Inch 0Millimeter
Bore	2.438 Inch 61.925 Millimeter